

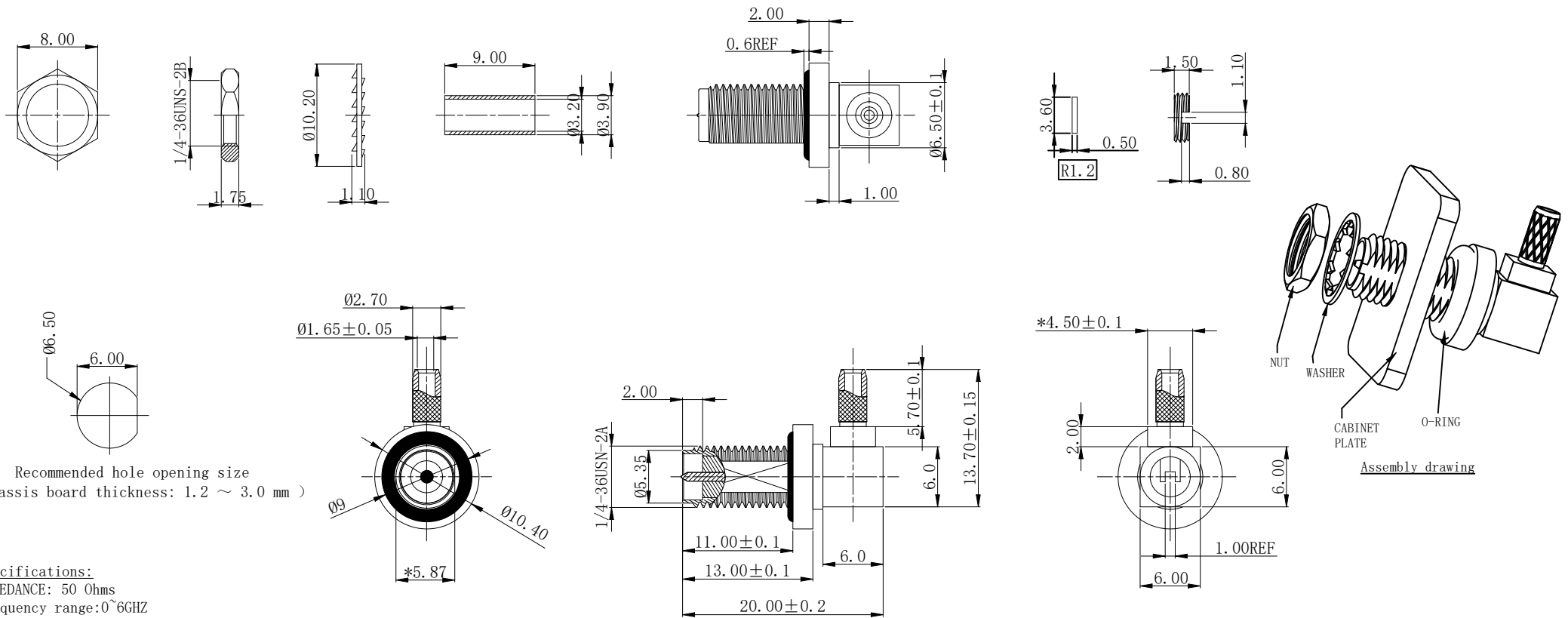

ISSUE	DESCRIPTION	DWN	DATE	APPROVEN
R1.0	First issue	Gavin	2023/09/22	JIM. KING
R1.1	Add the assembly schematic diagram	Li	2026/01/31	Jason
R1.2	Dimensional Change	Li	2026/03/13	Jason



Recommended hole opening size
(chassis board thickness: 1.2 ~ 3.0 mm)

Specifications:
 IMPEDANCE: 50 Ohms
 Frequency range: 0~6GHZ
 VSWR: 1.5MAX
 Voltage Rating: 335 Volts RMS Continuous
 Dielectric withstand voltage: 1000 V
 Service life: ≥500
 Insulation Resistance ≥5000MΩ
 Center contact resistance: ≤3mΩ
 Outer resistance: ≤2mΩ
 Operation Temperature: -55℃ ~ +165℃
 Waterproof Range: IP67, Mated

NO	DESCRIPTION	MATERIAL	FINISH	QTY
7	COPPER TUBE	BRASS	NICKEL PLATED	1
6	NUT	BRASS	GOLD PLATED	1
5	INSULATING GASKET	PTFE	NATURE	1
4	O-Ring	RUBBER	RED	1
3	CENTER PIN	BRASS	GOLD PLATED	1
2	INSULATOR	PTFE	NATURE	1
1	BODY	BRASS	GOLD PLATED	1
NO	DESCRIPTION	MATERIAL	FINISH	QTY

-TOLERANCES-
UNLESS OTHERWISE
SPECIFIED

UNLESS OTHERWISE SPECIFIED
TOLERANCES FOR MILLIMETERS ARE:
0.5 - 8mm ± 0.10mm
8 - 30mm ± 0.15mm
30 - 120mm ± 0.20mm

RENHOTEC GROUP

PART DESCRIPTION:
RP WATERPROOF SMA JACK FOR RG316 CABLE

P/N: RHT-612-6010

Appr:	Date	Scale	Unit	Type	Page
Check: Jason	2026.03.13	Free	MM	Z	1/1
Draw: Li					